

Euro Cylinder ECD Series



Application

A2 ECD Series cylinder is euro cylinder with dimpled pin system suitable for commercial or residential application to provide extra security

Specifications and Features

- Standard euro profile dimension according to DIN18252
- Solid brass body and keys
- Reversible key operation (double sided dimpled keys)
- Various lengths available for different door thickness
- Symmetrical and asymmetrical variant available to work with different lock installation position
- 6 pins construction to maximize key combination & security
- Anti-drill pins and Anti-pick pins available upon request
- Enhanced attack resistance provided by A2 security

Standards and Certification



Successfully type-tested for conformity to all of the requirements of EN1303:2005



Successfully passed 240-minutes fire test of metal door assemblies to EN1634-1:2014



All test performed independently and certified by Exova/Warringtonfire/ Warrington APT. Test reports and/or certificates are available on request

EN1303:2005 Classification

1	6	0	1	0	C	5	2
---	---	---	---	---	---	---	---

Finishes

- Satin Nickel (SN)
- Nickel Plated (NP)
- Brass Polished (BP)
- Antique Brass (AB)

A2 Profile Cylinder

Euro Cylinder ECD Series

Available Models

Double Profile Cylinder

Application: Keyed operation from either side (inside or outside).

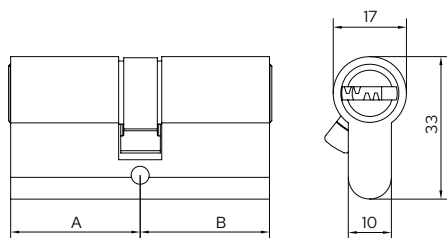

Item No.	A (30-60mm)	B (30-60mm)
ECD3030	30	30
ECD3035	30	35
ECD3535	35	35
ECD3540	35	40

* Dimensions in mm

Double Profile Cylinder with Thumb-turn

Application: Keyed operation from one side (outside) and thumb-turn operated from the other side (inside).

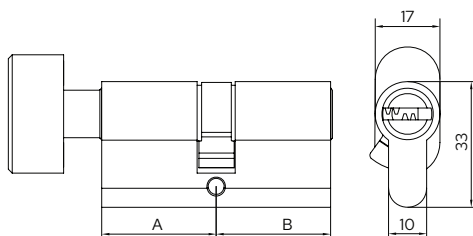

Item No.	A (30-60mm)	B (30-60mm)
ECD3030TK	30	30
ECD3035TK	30	35
ECD3535TK	35	35
ECD3540TK	35	40

* Dimensions in mm

Single Profile Cylinder

Application: Keyed operation from one side (outside) and thumb-turn operated from the other side (inside).

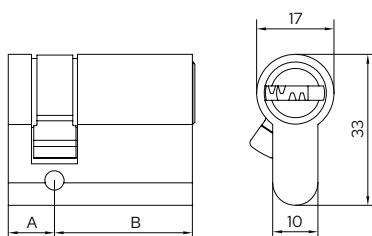

Item No.	A	B (30-60mm)
ECD1030	10	30
ECD1035	10	35
ECD1040	10	40
ECD1045	10	45

* Dimensions in mm