



A2 Sweden Presents  
**Smart Locks for Smart Living**

A2 VISO  
Smart Lock



Secure your loved ones with the best

---



### **VISO Smart Lock**

Allows you to access the door with face recognition, fingerprint, PIN, card or simply via A2 Smart Living App.

The best solution you can ever get for your family.

**Fully Automatic.**  
**Full Security.**  
**Full Freedom.**





Height Recognition Range 120cm-200cm

Face Recognition Distance 30cm-100cm

## A2 FaceScan

---

Achieve banking-level security with the cutting-edge Biometric Facial Recognition Technology of the A2 Smart Lock. Simply stand in front of the lock, and experience doors unlocking in an instant, without any physical contact.

### Easy at Night

With the high sensitivity Low Light 3D Sensors, you can unlock the door even without turning the light on at night. Even with make-up or hat.

< **0.0001%**  
False Acceptance Rate

< **0.001%**  
Error Rate



  
SILENT LOCKS  
REDUCE NOISE  
BY **50%**<sup>#</sup>

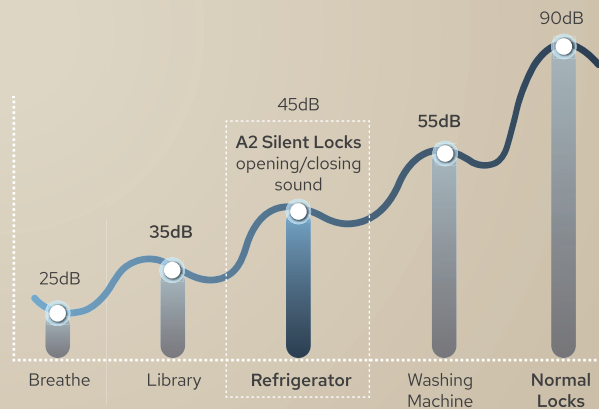

## The Fully Automated Silent Lock

Innovation is at our core value. Your family's safety and comfort is always in our minds while designing our products.

A2 fully automated Silent lock ensures smooth & silent opening and closing of the door. Flippable latch, latch guide sleeve, customized motor and geared linkage offers quick and almost mute operation

<sup>#</sup>Compared with traditional door locks





## Ease of Communication from anywhere with Visual Intercom

---

Someone ringing your doorbell can be easily monitored by simply tapping the pop-up window on your phone with A2 Smart Living App by initiating a video call and see who's there in real-time. Be doubly sure about your home's entrance with A2 Smart Lock's seamless integration.



The door bell auto wake up,  
when someone approach

## A2 Smart LivingApp

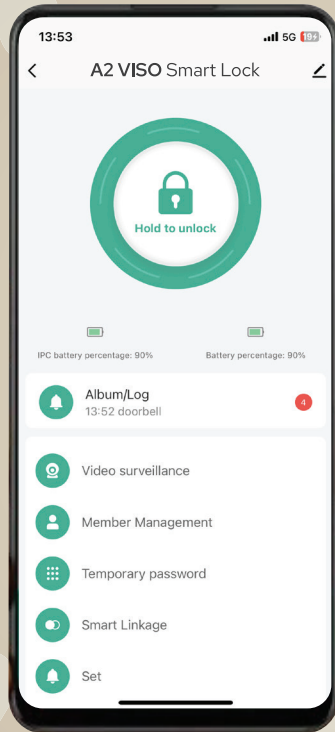

### Door Access

Unlock your front door remotely

### User Management

Add or delete face/fingerprint/password/card via mobile App.

### Door Lock Status

Lock/Unlock status, networking status and visual monitoring.

### Family Member Management

Invite other App users join the family member to share smart devices.

### Unlocking History

Knows who and when unlock the lock with fingerprint/password/card/App.

### Dual Verification

Once enabled, you need input 2 unlocking methods to unlock (fingerprint+password, fingerprint+card, card+password)

### Quantity of Users

Face: 20 - Fingerprint: 100  
Password: 20 - Card: 100

## Full Control at Your Fingertips

Turn your smartphone into your key. The intuitive A2 Smart Living App lets you manage the access of your door lock remotely from anywhere in the world





## Effortless Security

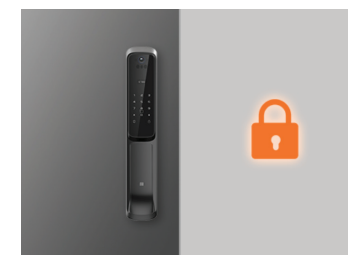
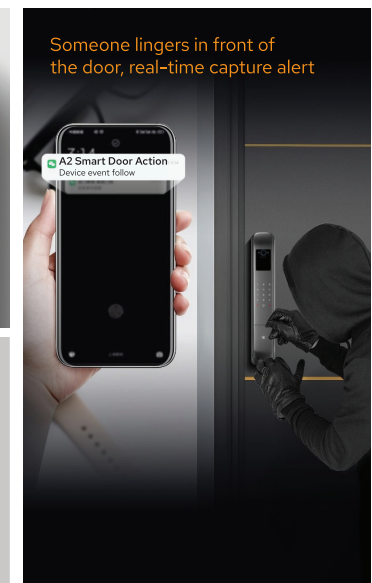
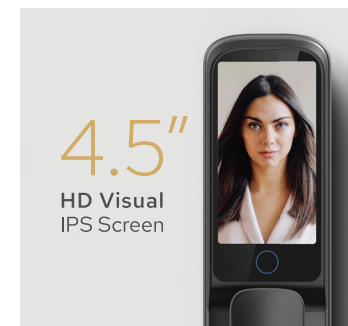
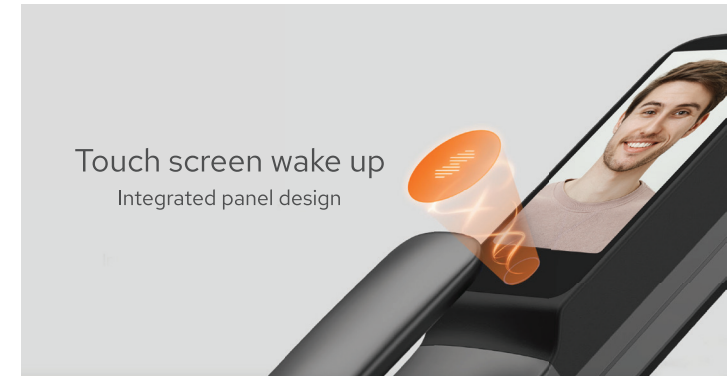

Automatically locks the door when closed

Burglar Alarm



## A2 VISO Smart Lock

---

Elevate your lifestyle starting at your doorstep.

Bring home the latest in technology and best in class features lock from A2. Thoughtfully designed to fit your new way of Smart Life.

Look no further.



Face Scan



Finger print



Card



PIN Code



Mobile App



Mechanical  
Key



# A2 VISO Smart Lock



Champagne Gold



Anti-Pinch Hand Pad



Fingerprint on Handle Back



Matte Black



High Security Cylinder



Emergency Power Mechanical Key

## Smart Features

- Single Push Action
- Built-in Doorbell
- High Security Mortise Lock
- Privacy Mode
- Dual Authorisation Mode
- Security Alarms
- Low Battery Alarm
- Emergency Power
- Indicating Light
- English Voice Prompt

Face Recognition	Up to 20
Fingerprint	Up to 100
PIN Code	Up to 20
IC Cards	Up to 100
Mortise Lock	Silent Lock, High Security SS 304
Mechanical Key	2 Nos
Main Body	75(W) x 420(H) x 62(D)mm
Back Body	75(W) x 420(H) x 41(D)mm
Backset	60mm
Battery	1PCS 5000Mah Lithium Battery + 4PCS AA Alkaline Batteries
Emergency Power	5V Type C
Color	Champagne Gold   Matte Black

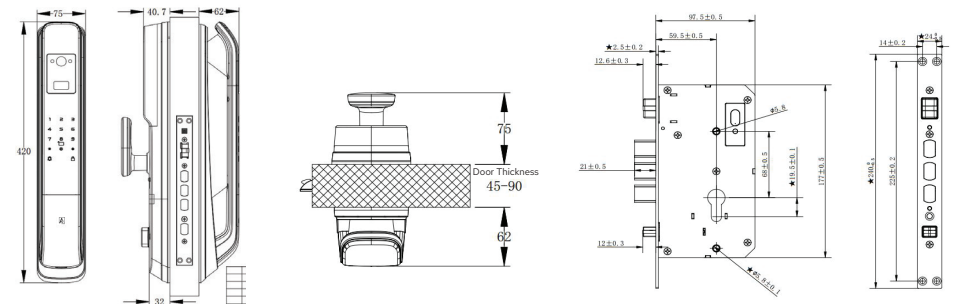



## SWEDEN

**A2 Building Solutions AB**  
Stora Wäsby, Upplands Väsby  
Sweden 19437

## DUBAI

**A2 Building Solutions**  
Unit 3509, 35<sup>th</sup> Floor,  
Burlington Tower, Business Bay,  
Dubai, UAE  
P.O. Box 417764

## INDIA

**A2 Building Solutions India Pvt. Ltd.**  
Unit No. 603 & 604,  
Welldone Tech Park, Sector 48,  
Gurugram, Haryana

SMART LOCKS